

Getting to know Bluetooth

Bluetooth wireless is a quick and easy way to connect a smartphone to a speaker or headset. There are basically two steps to making it work.

"Hi. I'm a phone."



"Hi, phone. I'm a speaker."



PAIRING:
The two devices get to know each other.



CONNECTING:
The two devices do something together (like play music).

This guide takes you through the steps to get started.

Step 1: Unpack

Make sure the following items came in this package.

- Thump wireless speaker
- Micro USB charging cable

Step 2: Charge up!

Before you start using your Thump speaker, you need to charge its built-in battery.

Plug the included USB charging cable into the DC IN jack on the back of the speaker.

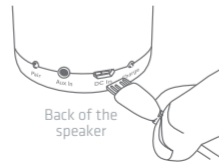

Plug the other end of the charging cable into a USB power source (like a computer or a USB charger).

The charging indicator on the back of the speaker illuminates while the speaker is charging. It turns off when the speaker is fully charged.



Back of the speaker

Step 3: Turn on

Press the  button on the bottom of the speaker to turn the speaker on.



The speaker beeps and the PAIR light on the front of the speaker starts blinking.



Back of the speaker

Step 4: Pair + Connect

Enable Bluetooth on your smartphone or other device.

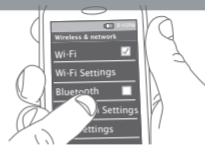

Make sure the PAIR light on the back of the speaker is blinking rapidly. (If it isn't, press and hold the  button on the bottom of the speaker until the speaker beeps.)



Back of the speaker

If you've previously paired your phone or other Bluetooth device with this speaker, the speaker will automatically attempt to reconnect to that device when you switch the speaker on. If you want to pair to a new device, press and hold the  button on the bottom of the speaker until the speaker beeps.

Choose 808 THUMP from the pairing options on your smartphone. (If it's not in the list, choose "Scan" from your phone's Bluetooth menu.)

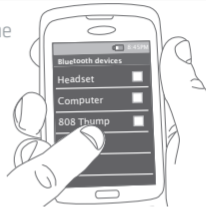

The speaker beeps when it's finished pairing and connecting to your smartphone. The PAIR light on the front of the speaker turns solid blue.



Back of the speaker

Note: The process of enabling Bluetooth and connecting varies from device to device. See your device's owners manual for more information and specific instructions.

Bluetooth Wireless Connection Tips

- Make sure the Bluetooth capability of your phone is turned on.
- Make sure there's nothing plugged into the Thump speaker's AUX IN jack when you're trying to use Bluetooth.
- The speaker's Bluetooth wireless connection works up to a range of roughly 33 feet (10 meters). This range may vary, however, based on other factors, such as room layout, wall material, obstacles, your device's Bluetooth performance, etc. If you're having problems connecting to the Thump speaker, move closer to it.
- If your device asks you for a password to connect, use "0000".

Step 5: Play music

Set your device's volume for music to 75%.

Note: This is to make sure the sound from the speaker isn't too loud when you start streaming.



Start playing music or other audio on your device. Within seconds, the speaker starts streaming the audio wirelessly via Bluetooth.



To adjust the volume of your audio: Use the Volume controls on your phone.

Using the Aux In input

Use a 3.5mm audio cable (not included) to connect the audio output from your device to the AUX IN audio input on the speaker's back panel.

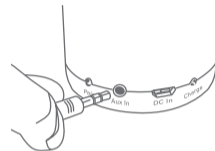

The speaker automatically switches to the AUX IN audio.

To listen to Bluetooth audio again, unplug the cable from the speaker's AUX IN jack.

Tour of the Thump speaker

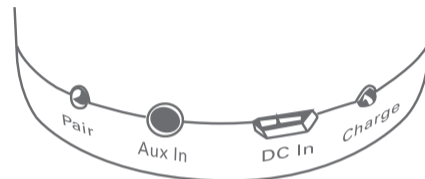

Back of the speaker

PAIR indicator light shows the status of the speaker:

- fast blinking blue while pairing
- slow blinking blue while reconnecting
- very slow blinking blue when disconnected and in standby mode
- solid blue when paired
- off when the speaker's off
- solid white when the AUX IN jack is in use

AUX IN jack lets you connect an audio device directly to the Thump speaker using a 3.5mm audio cable.

DC IN jack connects to the provided micro USB charging cable to recharge the speaker's battery.

CHARGE indicator light shows the charging status of the speaker: illuminated while charging, off when full (or unplugged).

Bottom of the speaker

⏻ button turns the speaker on or off.

📶 button puts the speaker into pairing mode to connect to a new Bluetooth device, like a smartphone.

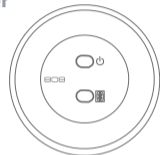

For more information about your new Thump speaker, visit 808Audio.com or call our toll-free help line at 1-800-732-6866.

SP200 QSG 00

808 | THUMP™

WIRELESS SPEAKER

Welcome!

Thank you for choosing the 808 Thump Wireless Speaker.

This Quick Start Guide has all the info you'll need to get started.