



DUO

quick start guide

let's DUO!  
*this guide shows you how*

## How to DUO:

808 DUO headphones give you two ways to enjoy your own personal concert: wirelessly and wired. This guide shows you how to get both set up.

### Unpack

Make sure you have the following items in your 808 DUO package:

- 808 DUO headphones
- Carrying case
- Round audio cable
- USB charging cable
- Flat audio cable with inline mic

If you have any questions about this product, visit [808Headphones.com](http://808Headphones.com) or call our toll-free help line at 1-800-732-6866.

## DUO Wired: Listen right away!

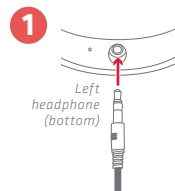

### 1 Plug in the headphones

Plug one of the included audio cables into the jack on the bottom of the left headphone.



### 2 Connect to your phone

Plug the other end into the headphone jack on your phone.

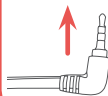

The flat cord provides inline push-to-talk and play/pause control for select mobile phones and other electronics.

Here's how it works:

**To play/pause music:** Single click.

**To skip to the next song:** Quick double click.

**To go back to the previous song:** Quick triple click.

**To answer/end a call:** Single click.

Please note that not all functions work with all brands and models of phones. Each phone's user interface works differently—see the user manual that came with your phone for more information. Certain devices may not support this cable—if you have any problems, use the other cable.

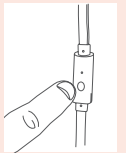

## DUO Wireless

### 1 Charge up the headphones

Before you start using your DUO headphones wirelessly, you need to charge their built-in battery.

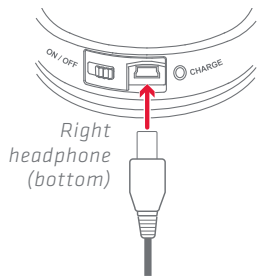

Plug the included USB charging cable into the CHARGE jack on the bottom of the right headphone.

Plug the other end of the charging cable into a USB power source (like a computer or a USB charger).

The charging indicator next to the CHARGE jack turns red while the headphones are charging. It turns blue when the headphones are fully charged.



### 2 Turn on the headphones

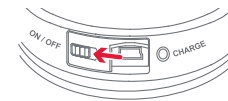

Right headphone  
(bottom)

Unplug the USB charging cable when the headphones are charged.

Move the switch on the bottom of the right headphone to the ON position.

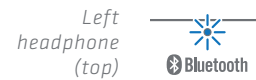

Left  
headphone  
(top)

The headphones beep and the pairing indicator on top of the left headphone begins blinking rapidly.

**IMPORTANT:** If you've previously paired your phone or other Bluetooth device with the 808 DUOs, the headphones will automatically attempt to reconnect to that device when you turn them on. If you want to pair to a new device, press and hold the  button on the back of the left headphone for 3 seconds to enter pairing mode.

Instructions continue on the other side...

## DUO Wireless (continued)

### 3 Pair + Connect

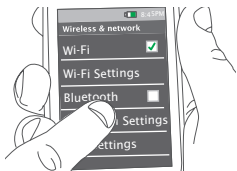

Enable Bluetooth on your smartphone or other device.

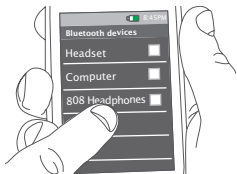

Choose 808 Headphone from the pairing options on your smartphone. (If it's not in the list, choose "Scan" from your phone's Bluetooth menu.)

The headphones beep when the process is complete. The pairing indicator on the top of the left headphone turns solid blue.

**Note: The process of enabling Bluetooth and connecting varies from device to device. See your device's owners manual for more information and specific instructions.**

#### Bluetooth Wireless Connection Tips

- Make sure the Bluetooth capability of your device is turned on.
- Make sure there's nothing plugged into the jack on the bottom of the left headphone when you're trying to use Bluetooth.
- The headphone's Bluetooth wireless connection works up to a range of roughly 33 feet (10 meters). This range may vary, however, based on other factors, such as room layout, wall material, obstacles, your device's Bluetooth performance, etc. If you're having problems connecting to the headphones, move closer to your phone.
- Make sure your device supports audio transfer A2DP.
- If your device asks you for a password to connect, use "0000".

#### To pair the headphones again

After turning your headphones back on, they automatically attempt to reconnect to the last connected device. If the last connected device is not available, the headphones will enter pairing mode and be ready to receive a connection.

## Using DUO Wirelessly

### Listening to music

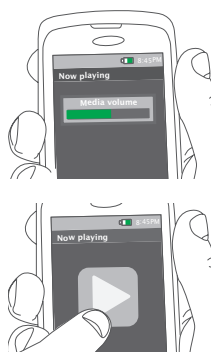

Set your device's volume for music to 50%.

**Note:** This is to make sure the sound from the headphones isn't too loud when you start streaming.

Start playing music or other audio on your device. Within seconds, the headphones start streaming the audio wirelessly via Bluetooth.

**Note:** Bluetooth playback is disabled when something is connected to the jack on the bottom of the left headphone. To use Bluetooth, make sure nothing's plugged in to this jack.

### Controlling playback and volume

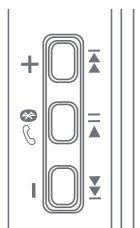

Left headphone (back)

The left DUO headphone has a control panel on its back that lets you control music playback and volume wirelessly.

**To play/pause music:** Press the ►|| button on the left headphone.

**To adjust volume:** Press and hold the + or – buttons on the left headphone.

**To go to the previous/next song:** Press the ◀◀ (back) or ▶▶ (forward) button on the left headphone.

### Answering/ending phone calls

The DUO headphones have a built-in microphone, so you can use them for phone calls. Your phone will ring through the headphones when you're receiving a call. You can answer and end the call wirelessly from your headphones using the controls on the left headphone.

**For best results during phone calls,** use the cable with the inline mic. In most cases, this cable's microphone will provide better performance than the headphones' built-in mic.

**To answer or end a phone call:** Press the 📞📶 button on the left headphone.

**IMPORTANT:** Not all phones support playback control and phone answer/end control. Check your phone's user manual for more information if you're having trouble with these functions.